

## DIMENSIONES DE PERFILES DE EPDM: VARIOS

**Tubo rectangular**

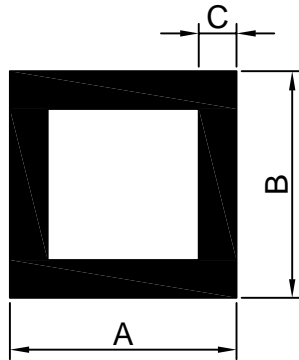

A: Ancho exterior  
B: Alto exterior  
C: Grueso pared

**Macizo rectangular (Cintas)**

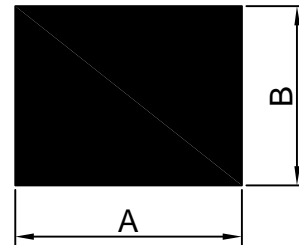

A: Ancho exterior  
B: Alto exterior

**Perfil U**

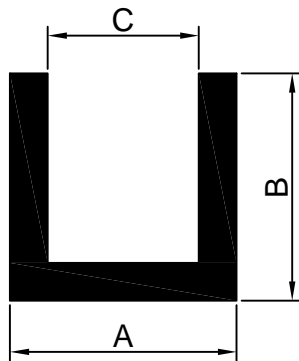

A: Ancho exterior  
B: Alto exterior  
C: Ancho hueco

**Perfil Angular**

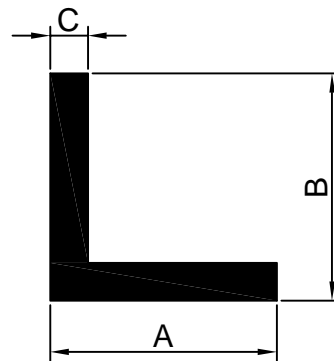

A: Ancho exterior  
B: Alto exterior  
C: Grueso pared

**Perfil H**

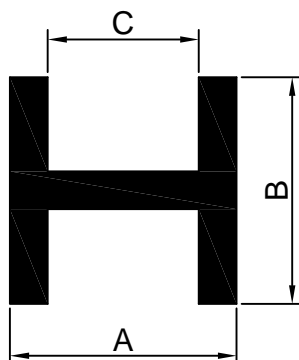

A: Ancho exterior  
B: Alto exterior  
C: Ancho hueco

**Perfil T**

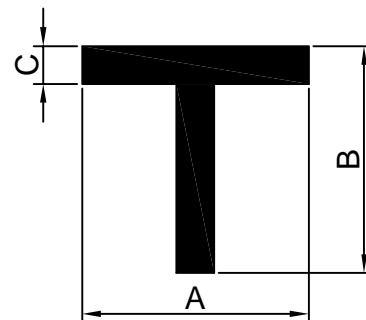

A: Ancho exterior  
B: Alto exterior  
C: Grueso pared

## DIMENSIONES DE PERFILES DE EPDM: VARIOS

**Perfil C**

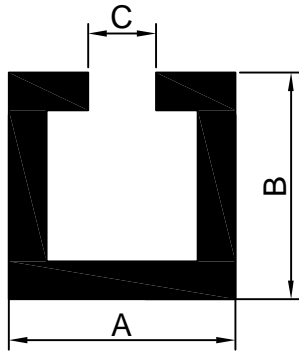

A: Ancho exterior  
B: Alto exterior  
C: Ancho abertura

**Cuña**

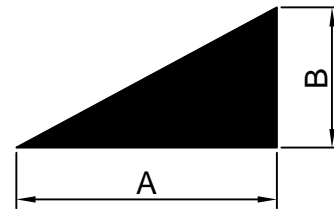

A: Ancho exterior  
B: Alto exterior

**Tubo redondo**

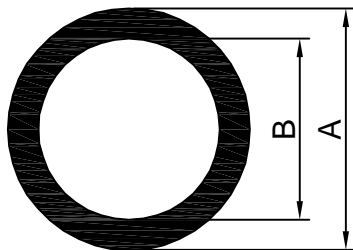

A: Diámetro exterior  
B: Diámetro interior

**Macizo redondo**

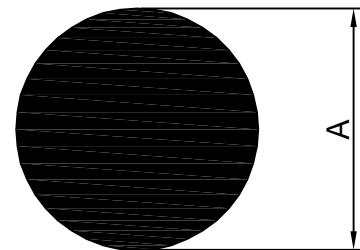

A: Diámetro exterior

**Funda protección tubular**

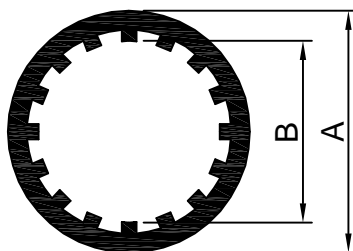

A: Diámetro exterior  
B: Diámetro interior

**Media caña**

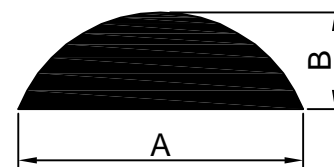

A: Ancho exterior  
B: Alto exterior

## DIMENSIONES DE PERFILES DE EPDM: VARIOS

### Junta abrazadera

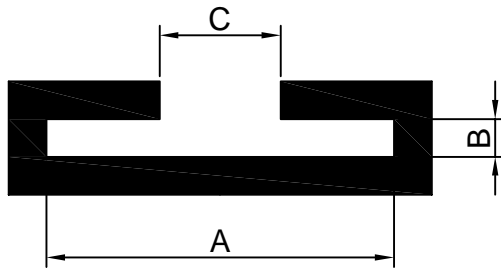

A: Ancho interior  
B: Alto interior  
C: Ancho abertura

### Junta estanqueidad canalizaciones

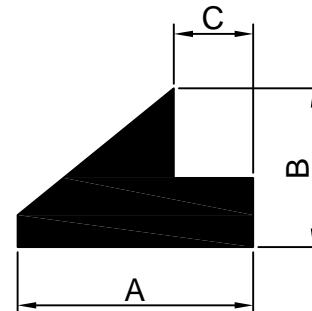

A: Ancho exterior  
B: Alto exterior  
C: Rebaje escalón

### Junta salvacantos

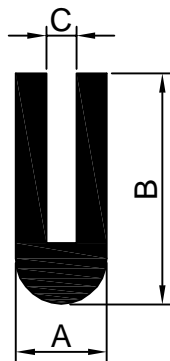

A: Ancho exterior  
B: Alto exterior  
C: Ancho hueco

### Junta protección (mesas de trabajo)

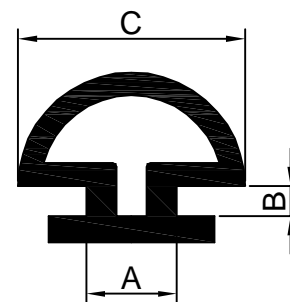

A: Ancho cuello  
B: Alto cuello  
C: Ancho exterior

### Junta parabrisas

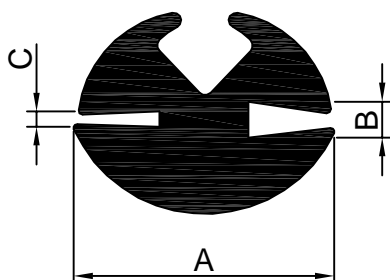

A: Ancho exterior  
B: Ancho hueco 1  
C: Ancho hueco 2

### Junta puertas frigoríficas

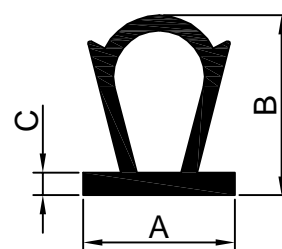

A: Ancho base  
B: Alto exterior  
C: Grosor base

## DIMENSIONES DE PERFILES DE EPDM: VARIOS

### Junta cubiertas y paneles

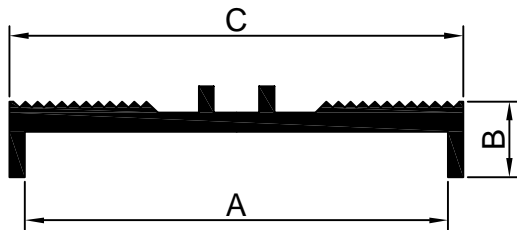

A: Ancho interior  
B: Alto interior  
C: Ancho abertura

### Junta Dilatación

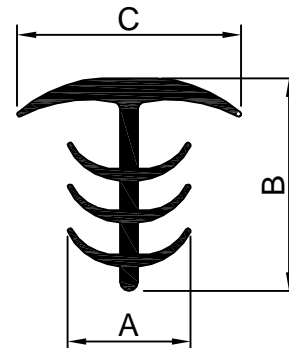

A: Ancho interior  
B: Alto total  
C: Ancho exterior

### Junta bajo puerta

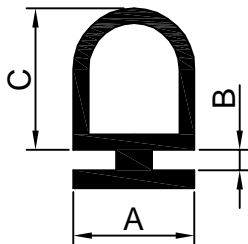

A: Ancho base  
B: Alto cuello  
C: Alto junta clipada

### Junta contenedores

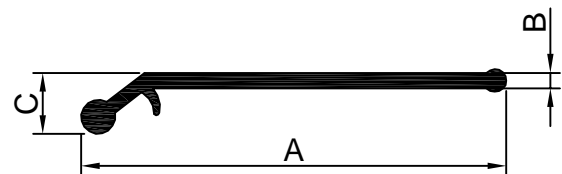

A: Ancho exterior  
B: Grueso pared  
C: Alto exterior

### Junta antipinzados

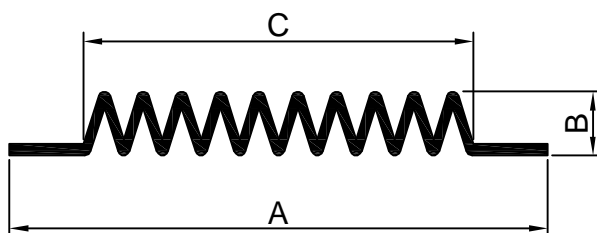

A: Ancho exterior  
B: Alto exterior  
C: Ancho fuelle

### Junta tapa canal

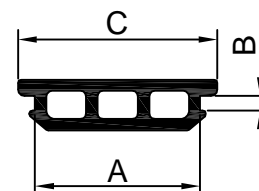

A: Ancho cuello  
B: Alto cuello  
C: Ancho exterior